



## Introduction

This manual provides detailed instructions for installing our OBC (On-Board Computer) bypass wire in 1995-2010 48V Club Car DS and 2004-2014 48V Club Car Precedent models. The bypass wire allows the vehicle's electrical system to function without the OBC, which may be necessary in cases of OBC failure.



## Safety Instructions

- **Disconnect the Power Supply:** Always disconnect the battery pack before beginning any electrical work.
- **Avoid Short Circuits:** Use electrical tape to insulate any exposed wires.
- **Work in a Well-Ventilated Area:** Batteries emit gases that may be harmful in enclosed spaces.
- **Wear Protective Gear:** Use insulated gloves and safety goggles to protect yourself from potential hazards.
- **Follow Our Guidelines:** Ensure all steps are followed carefully to avoid



## Required Tools and Materials

### OBC bypass wire (Provided) :

- M8-M6 terminal ring for 1995-2010 48V Club Car DS models
- M8 terminal ring for 2004-2014 48V Club Car Precedent models
- Electrical tape (Not Provided)
- Phillips Screwdriver (Not provided)



## Compatibility Information



Use M8-M6  
Terminal Ring Wire for  
1995-2010 48V Club



Use M8 Terminal  
Ring Wire for  
2004-2014 48V Club  
Car Precedent

**1995-2010 48V Club Car DS models:**  
Use M8-M6 terminal ring wire.

**2004-2014 48V Club Car  
Precedent models:**  
Use M8 terminal ring wire.



## Installation Instructions



### Disconnect the Charging Plug

- ① Lift & remove the seat of the golf cart.
- ② Switch the golf cart to Tow Mode.
- ③ Identify the main positive (+) and main negative (-) battery terminals of your battery pack.
- ④ Using appropriate tools, disconnect both the main positive and main negative cables from the battery pack.
- ⑤ Locate the charging plug on the vehicle.
- ⑥ Use a Phillips screwdriver to loosen the screw of the charging plug.
- ⑦ Ensure the plug is free from the socket.

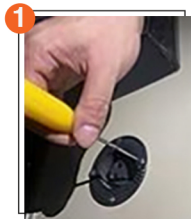

# OBC Bypass Manual

## STEP 2 Unplug the Charging Wire

Please follow the below steps for your Club Car model:

### **1994-2010 48V Club Car DS**

- ① Identify the wire on the left side of the charging socket.
- ② Unplug the wire completely from the socket. Ensure this is completely unplugged.
- ③ Take the washer, nut & plug off of the socket. Do not lose the washer & nut.

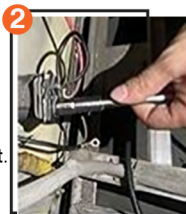

### **2004-2014 48V Club Car Precedent**

- ① Connect the supplied OBC bypass wire to the previously disconnected Packard connector.
- ② Disconnect the single Packard connection that links the vehicle's charging receptacle to the OBC.

## STEP 3 Secure the Unused Cable

- ① The unplugged cable is no longer needed for operation.
- ② Wrap the cable securely with electrical tape to prevent accidental contact or electrical shorts.

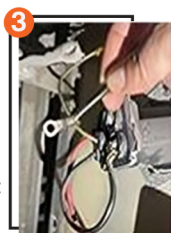

## STEP 4 Connect the Bypass

### **Please follow the below steps for your Club Car model**

#### **1995-2010 48V Club Car DS**

- ① Replace the disconnected wire with the smaller M6 Terminal OBC bypass wire ( M8-M6 terminal ring).

#### **2004-2014 48V Club Car Precedent**

- ① Connect the supplied OBC bypass wire to the previously disconnected Packard connector.

**Tighten the connection securely using a wrench to ensure stability.**



## STEP 5 Connect to the Negative Terminal

- ① Locate the negative terminal (the negative terminal of the last battery) of the battery pack.
- ② Attach the larger M8 terminal ring of the bypass wire to the negative terminal.
- ③ Tighten the connection securely with a wrench.
- ④ Reconnect the charging plug with the Washer & nut removed in step 1.6.

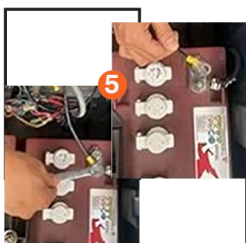



## Wiring Diagram

Refer to the included wiring diagram for the correct configuration of the bypass wire.

The bypass wire connects to the following components:

- Fuse and receptacle
- Battery pack (negative terminal)
- Vehicle electrical system

Ensure all connections match the diagram to avoid improper installation.

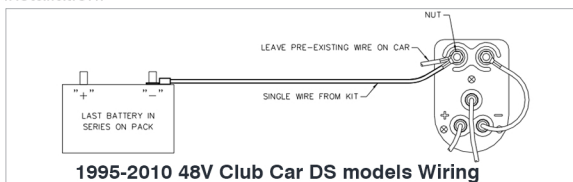

**1995-2010 48V Club Car DS models Wiring**

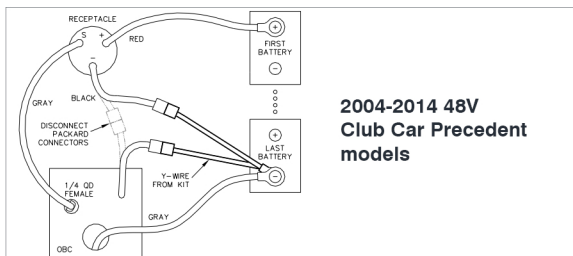

**2004-2014 48V  
Club Car Precedent  
models**



## Troubleshooting

### PROBLEM

# 1

#### Vehicle Does Not Charge After Installation

**Cause:** Loose connection at the bypass wire or battery terminal.

**Solution:**

Check all connections and tighten if necessary. Verify that the bypass wire is compatible with your model.

### PROBLEM

# 2

#### Electrical System Malfunctions

**Cause:** Improper insulation of unused wires.

**Solution:**

Ensure all unused wires are wrapped securely with electrical tape. Inspect for any exposed wires and insulate them properly.

### PROBLEM

# 3

#### Battery Drains Quickly

**Cause:** Faulty connection or damaged bypass wire.

**Solution:**

Inspect the bypass wire for damage and replace it if necessary. Ensure connections are secure and match the wiring diagram.



Visit : [www.partsworldusa.com](http://www.partsworldusa.com)



Email us: [support@partsworldusa.com](mailto:support@partsworldusa.com)